

GENERAL DESCRIPTION / APPLICATIONS



Three way direct acting solenoid valve with spring return.

Suitable for gaseous and liquid media compatible with the (body/seals) material used, vacuum.

Forged brass, nickel-plated brass or stainless steel body.

Stainless steel internal parts.

Stainless steel springs.

360° degrees orientable solenoid.

Mountable in any position.

DIMENSIONS (in mm)

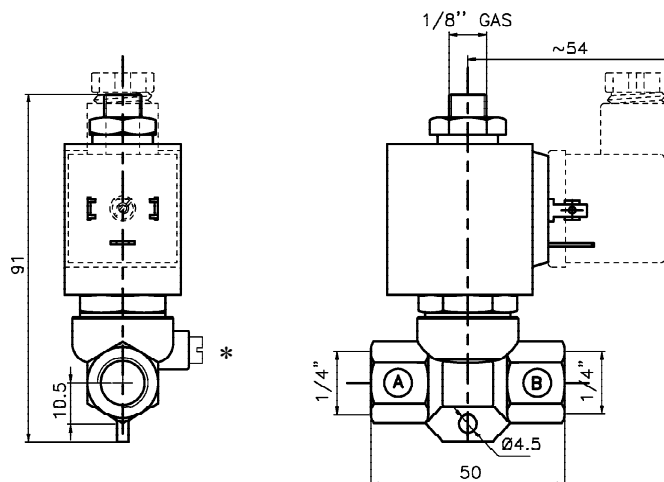

* Optional Manual Operator

ELECTRICAL INFORMATION

Continuous duty glass-reinforced nylon moulded coil with electrical connection suitable for DIN-43650A plug (2 poles+ground) or "faston" wire terminal.

Coil type :	B2
Insulation class:	F (155°C) - H (180°C) upon request.
Winding wire class:	H (180°C)
Protection class:	Waterproof IP-65 (EN60529 standards) when properly plug connected with DIN-43650A plug.
Duty:	Continuous (S.I.) 100% ED
Power consumption:	Alternate Current 10VA (inrush 20VA) Direct Current 8W
Voltage tolerance:	± 10%
Electrical Insulation:	>1000 MOhm
Dielectrical Strength:	>2000 V/1'
Standard voltages:	12 - 24 - 48 - 110 - 220 Vac~ 50/60Hz 12 - 24 - 48 - 110 - 220 Vdc= other voltages available upon request.

OPERATION

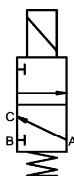

C02 - Normally closed.

In:	B
Out:	A
Vent:	C
Coil de-energized:	Input B closed from B to vent C
Coil energized:	from A to B vent C closed

SPECIFICATIONS AND AVAILABLE OPTIONS

MODEL					ORIFICE DIAMETER	BODY RATING	PRESSURES IN BAR ₍₁₎			Flow factor kv (liters/min.')	WEIGHT Kg.
a	b	c	d	e			MIN./MAX. OPERATING DIFFERENTIAL PRESSURE				
C 0 2	1 8				mm		MIN.	MAX. AC~	MAX. DC=		
C 0 2	1 8				1,8	10	0	10	10	1	0,3
C 0 2	2 5				2,5	8	0	8	8	1,6	0,3

suffix (options available upon request): ⁽¹⁾ "AP" (High pressure version)

a	b	c	d	e
Body material	Port size	Seals material	Protection class	Optional feature
T Brass. N Nickel-plated brass. I Stainless steel.	C 1/4" GAS D 1/4" NPT Vent: 1/8" Gas	0 Buna N 1 FPM 6 EPDM	P IP 65 <i>when properly plug connected with DIN-43650A plug.</i>	X Stable manual operator.